

KGHM ZANAM

HT20

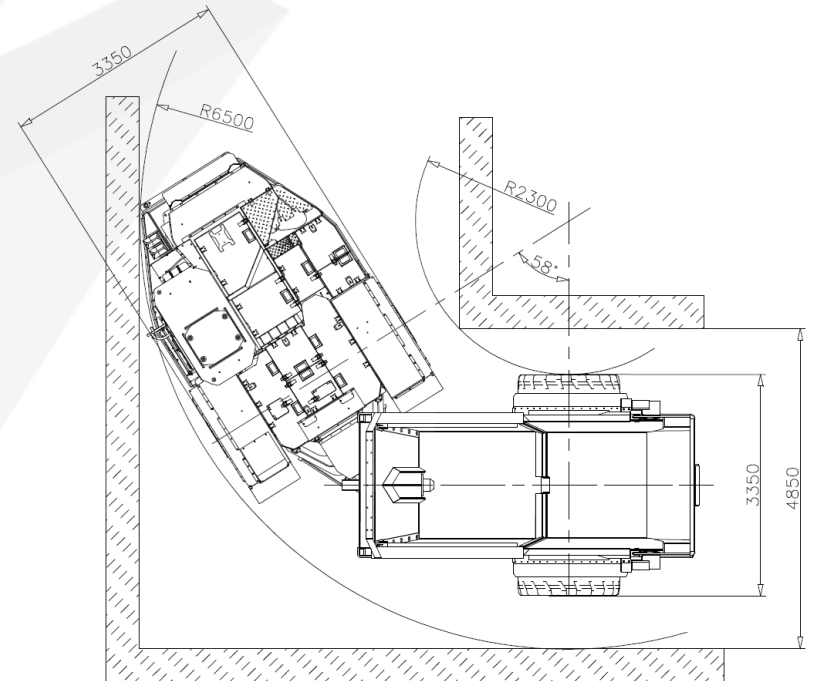
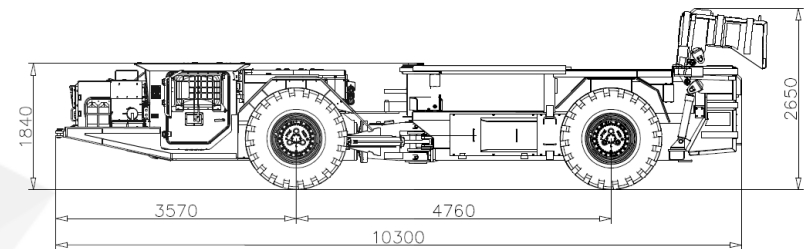

Length:	10 300 mm
Width:	3 440 mm
Height:	1 900/2 000/2 100 mm
Total weight:	26 320 kg
Capacity of the working element:	11,1 m ³
Working unit lifting capacity:	20 Mg
Power rating:	168 kW
Exhaust gas purity class:	Stage V
Driving speed:	1st gear 5,0 km/h
(forward/reverse)	2nd gear 9,0 km/h
	3rd gear 15,0 km/h
	4th gear 22,0 km/h